

IV-SNVR1600

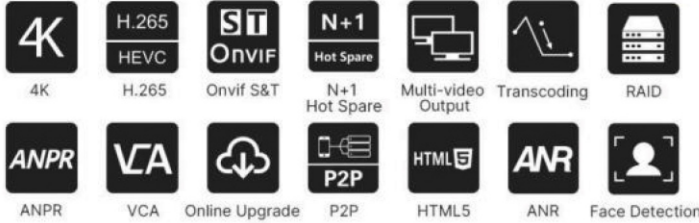

KEY FEATURES

- ▶ 16-CH Network Video Input (Up to 16 channel IP cameras can be connected.)
- ▶ H.265⁺ (H.265⁺ allows to cut down 70%~80% bandwidth while ensuring the high quality of images compared with H.264.)
- ▶ HTML5 Streaming Ready (Support previewing the video via all major browsers without plug-in when Video Codec is set to H.265.)
- ▶ Transcoding (Transcoding guarantees fluid video experience by reducing the stream data via lowering resolution, bit rate, or frame rate.)
- ▶ Versatile Interfaces (A whole array of ports provides all necessary features for effective surveillance.)
- ▶ Auto Backup (The latest 24 hours' video will be automatically backed up to USB Port Devices or NAS after setting up the backup.)

Power Decoding Capacity & Flexible Storage Options

- The 4K NVR is equipped with solid 4K decoding and display capabilities and maximum supports simultaneous viewing of 16*1080P
- Providing flexible storage options including HDD and NAS to address the needs for versatile storage.



Reliability and Usability

- RAID improves the disk reliability to ensure the recording security.
- ANR can store video data on the camera storage card when network between IPC and NVR is disconnected and retransfer the recorded video to NVR after network recovers.
- N+1 Hot Spare can keep the system working on and ensure the data integrity and reliability.

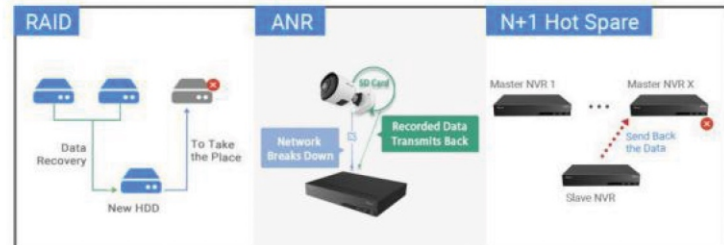

AI Video Analytics & POS Integration

- All-in-one to Manage AI & ANPR:
 - VCA Function focus on human and vehicle detection.
 - People Counting provides high-accuracy data and statistic reports.
 - Face Detection function supports attribute recognition.
 - Enterprise ANPR Management makes it easy to monitor traffic.
- POS machine information can be transferred to and displayed on the NVR.



Flexible Structure Options

- Multi-video Output in two ways: Independent Outputs and Synchronous Outputs
- Dual network ports provide three network working modes for more independence, and higher throughput and stability according to the specific applications and needs.

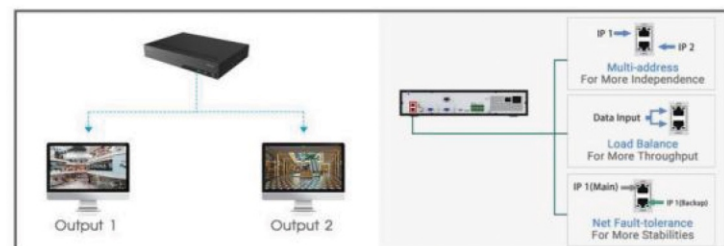

IV-SNVR1600

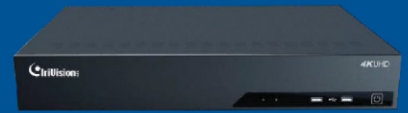

Model		IV-SNVR1600	
Video/Audio Input	Network Video Input	16-CH	
	Bandwidth	Incoming	160Mbps
		Outgoing	160Mbps
Video/Audio Output	HDMI Output	1-CH, Resolution: 3840x2160/60Hz, 3840x2160/30Hz, 1920x1080/60Hz, 1920x1080/50Hz, 1280x1024/60Hz, 1280x720/60Hz, 1024x768/60Hz HDMI Supports Audio Output	
	VGA Output	1-CH, Resolution: 1920x1080/60Hz, 1920x1080/50Hz, 1280x1024/60Hz, 1280x720/60Hz, 1024x768/60Hz	
	Dual Stream	Support	
	Recording Resolution	12MP/8MP/6MP/5MP/4MP/3MP/1080P/UXGA/720P/D1/VGA/CIF/QCIF	
	Synchronous Playback	4*(30fps @8MP), 5*(30fps @6MP), 6*(30fps @5MP), 8*(30fps @4MP), 10*(30fps @3MP), 16*(30fps @1080P), 16*(30fps @720P)	
Video/Audio Compression	Video Compression	H.265*/H.265(HEVC)/H.264*/H.264	
	Audio Compression	G.711/AAC/G.722/G.726	
	Sample Rate	8KHz/16KHz	
Storage	SATA	4*SATA HDD(3.5")	
	Capacity	Up to 10TB capacity for each HDD	
Disk Array	Array Type	RAID0, RAID1, RAID5, RAID6, RAID10	
Recording Management	Recording Type	Continuous, Event (Motion Detection, Alarm, VCA, Smart Analysis)	
	Snapshot Type	Continuous, Event (Motion Detection, Alarm, VCA, Smart Analysis)	
	Playback Type	General Playback, Event Playback, Tag Playback, Split Playback, Picture Playback	
Backup	Backup	Video Backup, Image Backup	
Network	Protocol	IPv4/IPv6, TCP, UDP, RTP, RTSP, RTCP, HTTP, HTTPS, DNS, DDNS, DHCP, NTP, SNTP, SMTP, SNMP, UPnP, NFS	
External Interface	Network Interface	2*RJ45 10/100/1000Mbps 1*RS-485 Series Port for PTZ	
	Serial Interface	1*RS-232 Series Port for Console 1*RS-485 Series Port for Keyboard	
	USB Interface	1*USB 3.0; 2*USB 2.0	
	Audio Input/Output	1*RCA/1*RCA	
	Alarm Input/Output	16-CH/4-CH	
	General	Compatibility	ONVIF, API
Advanced Function		ANR, N+1 Hot Spare	
ANPR		Support	
Video Analysis		Region Entrance, Region Exiting, Advanced Motion Detection, Tamper Detection, Line Crossing, Loitering, Human Detection, People Counting, Object Left, Object Removed	
Keyboard Control		IriVision Keyboard (MS-K01)	
Power Supply		AC 100V~240V 50Hz~60Hz	
Consumption		≤15W(Without HDD)	
Working Conditions		Temperature: -10℃~55℃/Humidity: 10%~90%	
Dimensions		Rack Mountable Chassis (1.5U Standard) 440mm(W)X320mm(D)X66.8mm(H)	
Weight		4.1Kg	
Warranty	3 Years		

IV-SNVR1600

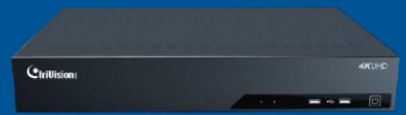

Interfaces

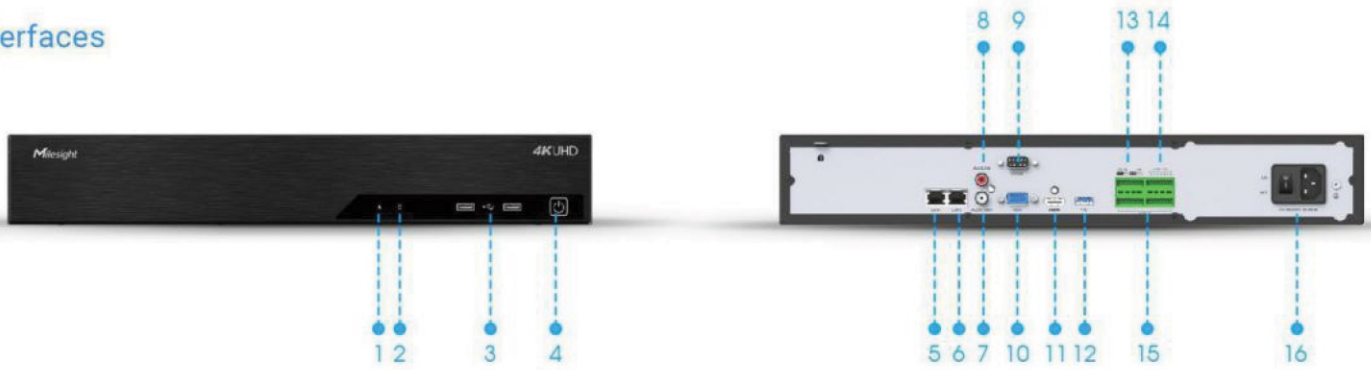

- 1. Run Indicator 2. HDD Indicator 3. USB 4. Power Light 5. LAN1 6. LAN2 7. Audio Out 8. Audio In
- 9. RS-232 10. VGA 11. HDMI 12. USB 13. RS-485 14. Alarm Out 15. Alarm In 16. Power

Installation of HDDs



Structure Diagrams

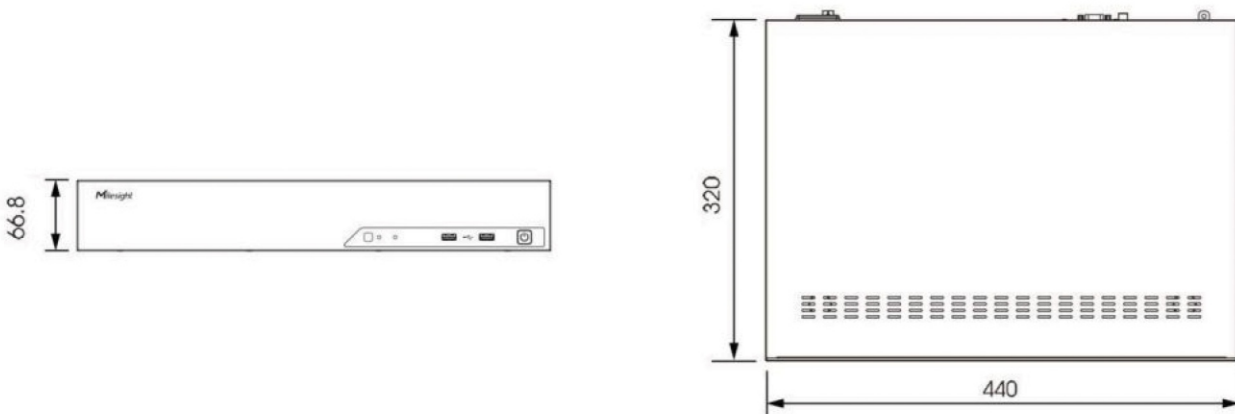

Units: mm

Naming Convention

