

4K H.265 Pro NVR

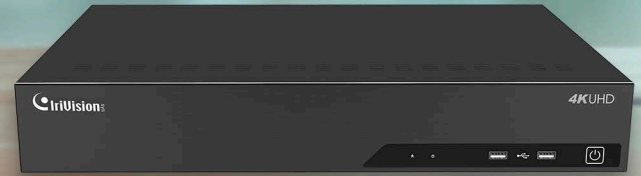

KEY FEATURES

- » **Powerful Decoding Capacity** (Maximum supporting 16*1080P or 32*720P network cameras viewing at the same time.)
- » **HDMI & VGA** (Providing both HDMI and VGA ports for users to choose according to their monitor types.)
- » **4*3.5" HDD** (4 SATA of 3.5" HDD, providing 10TB capacity for each HDD, up to 40TB total hard disk storage.)
- » **Dual LAN Interfaces** (Designed for three network working modes as Multi-address, Load Balance and Net Fault-tolerance.)
- » **Video Content Analysis** (With 10 detection modes, VCA greatly enhances the performance bringing comprehensive surveillance functions.)
- » **ANR** (Can automatically replenish the recording gap due to internet interruptions (by storing at the edge).)
- » **N+1 Hot Spare** (A backup mechanism which ensures the monitoring system uninterrupted working.)

H.265 + H.264

Smartly figure out and switch between H.264 and H.265 automatically. It will extend the days to save recording file with H.265 than with other compressions.

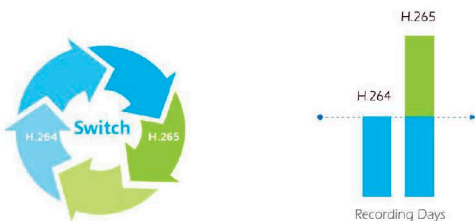

Multi-video Output

Independent Outputs: Multiple outputs to display various channels independently.
Synchronous Outputs: The same channel to be displayed at different locations synchronously.



Powerful Decoding Capacity

Maximum support up to 16*1080P or 32*720P network cameras viewing at the same time.



RAID 0/1/5/6/10

RAID (Redundant Array of Independent Disks) is a method of combining hard disks as a logical unit to achieve redundancy and greater speed of writing and reading data.

	RAID 0	RAID 1	RAID 10	No. of hard disk drives required	Total Storage Space
RAID 0				2	n/2
RAID 1				2	n/2
RAID 5				≥3	n-1
RAID 6				≥4	n-2
RAID 10				4, 6, 8	n/2

4K H.265 Pro NVR

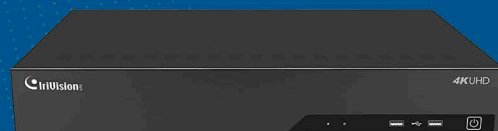

Model			IV-SNVR3200
Video/Audio Input	Network Video Input		32-CH
	Bandwidth	Incoming	256Mbps or 200Mbps(when RAID is enabled)
		Outgoing	256Mbps or 200Mbps(when RAID is enabled)
Video/Audio Output	HDMI Output		1-CH, Resolution: 3840x2160/60Hz, 3840x2160/30Hz, 1920x1080/60Hz, 1920x1080/50Hz, 1280x1024/60Hz, 1280x720/60Hz, 1024x768/60Hz HDMI Supports Audio Output
	VGA Output		1-CH, Resolution: 1920x1080/60Hz, 1920x1080/50Hz, 1280x1024/60Hz, 1280x720/60Hz, 1024x768/60Hz
	Dual Stream		Support
	Recording Resolution		12MP/8MP/6MP/5MP/4MP/3MP/1080P/UXGA/720P/D1/VGA/CIF/QCIF
	Synchronous Playback		4*(30fps @8MP), 5*(30fps @6MP), 6*(30fps @5MP), 8*(30fps @4MP), 10*(30fps@3MP), 16*(30fps@1080P), 32*(30fps@720P)
Video/Audio Compression	Video Compression		H.265*/H.265(HEVC)/H.264*/H.264
	Audio Compression		G.711/AAC/G.722/G.726
	Sample Rate		8KHz/16KHz
	Synchronous Recording		32*5MP
Storage	SATA		4*SATA HDD(3.5")
	Capacity		Up to 10TB capacity for each HDD
Disk Array	Array Type		RAID0, RAID1, RAID5, RAID6, RAID10
Recording Management	Recording Type		Continuous, Event (Motion Detection, Alarm, VCA, Smart Analysis)
	Snapshot Type		Continuous, Event (Motion Detection, Alarm, VCA, Smart Analysis)
	Playback Type		General Playback, Event Playback, Tag Playback, Split Playback, Picture Playback
Backup	Backup		Video Backup, Image Backup
Network	Protocol		IPv4/IPv6, TCP, UDP, RTP, RTSP, RTCP, HTTP, HTTPS, DNS, DDNS, DHCP, NTP, SNTP, SMTP, SNMP, UPnP, NFS
External Interface	Network Interface		2*RJ45 10/100/1000Mbps
	Serial Interface	1*RS-485 Series Port for PTZ	
		1*RS-232 Series Port for Console	
		1*RS-485 Series Port for Keyboard	
	USB Interface		1*USB 3.0; 2*USB 2.0
	Audio Input/Output		1*RCA/1*RCA
General	Alarm Input/Output		16-CH/4-CH
	Compatibility		ONVIF, API
	Advanced Function		ANR, N+1 Hot Spare
	ANPR		Support
	Video Analysis		Region Entrance, Region Exiting, Advanced Motion Detection, Tamper Detection, Line Crossing, Loitering, Human Detection, People Counting, Object Left, Object Removed
	Keyboard Control		IriVision Keyboard (IV-K01)
	Power Supply		AC 100V~240V 50Hz~60Hz
	Consumption		≤15W(Without HDD)
	Working Conditions		Temperature: -10℃~55℃/Humidity: 10%~90%
	Dimensions		Rack Mountable Chassis (1.5U Standard) 440mm(W)X320mm(D)X66.8mm(H)
	Weight		4.1Kg
	Warranty		2 Years

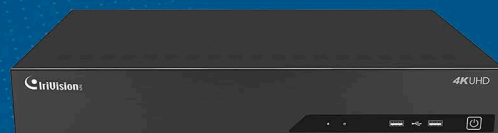

Interface

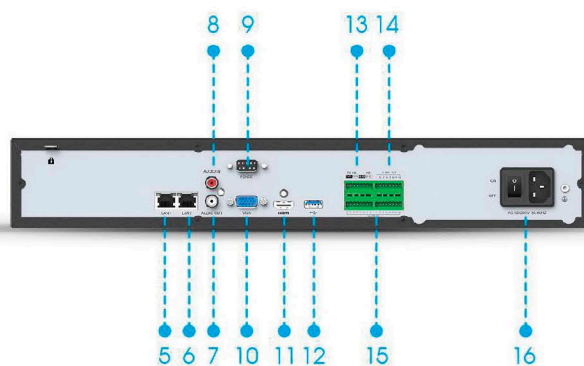

1. Run Indicator 2. HDD Indicator 3. USB 4. Power Light 5. LAN1 6. LAN2 7. Audio Out 8. Audio In
9. RS-232 10. VGA 11. HDMI 12. USB 13. RS-485 14. Alarm Out 15. Alarm In 16. Power

Installation of HDDs

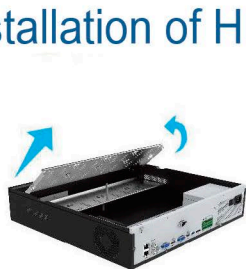

Step1

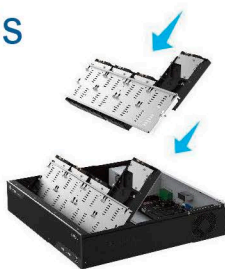

Step2



Step3



Step4



Step5

Structure Diagrams

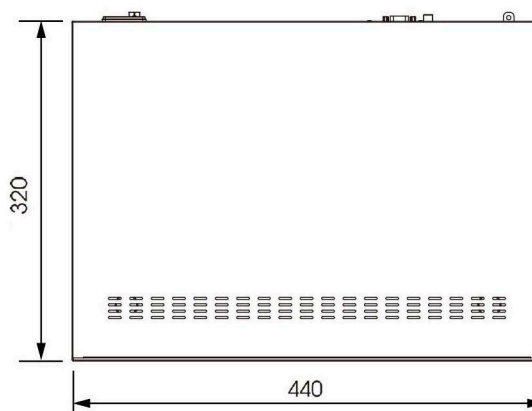

Units: mm

